



Sheraton

FIRST FLOOR
GUILFORD
BALLROOM



ROOM DIMENSIONS AND SEATING CAPACITY

Room Name	Reception or Theatre	Classroom	Banquet	Ovals of 10	Length X Width	Square Feet	Ceiling Height
Gate City		Permanent Conference for 14			25' x 17'	425	11'
Biltmore	100	55	75	60	36' x 28'	1,008	11'
Biltmore A	45	25	40	20	28' x 18'	504	11'
Biltmore B	45	25	40	20	28' x 18'	504	11'
Morehead	60	30	55	40	28' x 25'	700	11'
Blandwood	60	30	55	40	28' x 25'	700	11'
Carolina	40	27	30	30	26' x 24'	624	11'
Old North		Permanent Conference for 16			25' x 22'	550	11'
Cardinal		Permanent Conference for 10			23' x 19'	437	11'
Auditorium II		Permanent Classroom Seating for 154					
Auditorium III		Permanent Classroom Seating for 154					
Prefunction Area		30,000 Square Feet					
Guilford Ballroom	6,000	2,800	4,075	2,880	200' x 200'	40,000	32'
Guilford A	(R) 600 (T) 555	280	350	320	90' x 50'	4,500	32'
Guilford B	1,100	520	700	560	100' x 90'	9,000	32'
Guilford C	555	280	350	320	90' x 50'	4,500	32'
Guilford D	550	280	350	320	90' x 50'	4,500	32'
Guilford E	580	280	350	320	90' x 50'	4,500	32'
Guilford F	580	280	350	320	90' x 50'	4,500	32'
Guilford G	550	280	350	320	90' x 50'	4,500	32'
Corridor					200' X 20'	4,000	32'

Sheraton Greensboro Hotel at Four Seasons

GREENSBORO, NORTH CAROLINA

3121 High Point Road

t — 336 292 9161

sheratongreensboro.com

FIRST FLOOR
IMPERIAL
BALLROOM

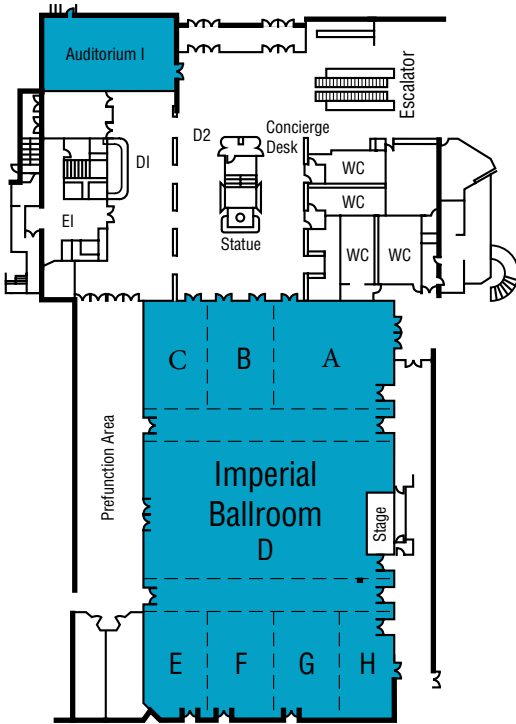

SECOND FLOOR
MEETING
ROOMS

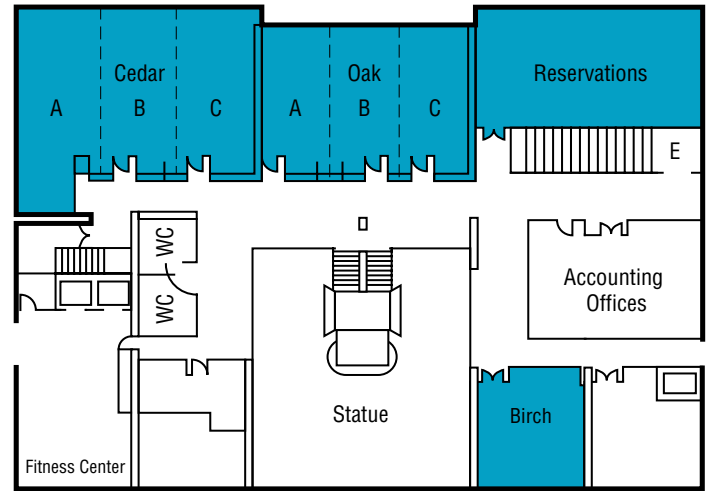

ROOM DIMENSIONS AND SEATING CAPACITY

Room Name	Reception or Theatre	Classroom	Banquet	Ovals of 10	Length X Width	Square Feet	Ceiling Height
Imperial Ballroom	1,900	1,200	1,190	1,000	165' x 100'	16,500	16'-20'
Imperial A	185	125	150	110	48' x 43'	2,064	16'-18'
Imperial B	115	65	75	60	43' x 26'	1,118	16'-18'
Imperial C	110	60	70	60	43' x 25'	1,075	16'-18'
Imperial D	600	360	435	370	100' x 54'	5,400	16'-20'
Imperial E	75	35	50	40	42' x 25'	1,050	16'-18'
Imperial F	115	50	70	60	42' x 26'	1,092	16'-18'
Imperial G	115	50	70	60	42' x 26'	1,092	16'-18'
Imperial H	85	30	50	40	42' x 22'	924	16'-18'
Additional each aisle					100' x 13'	1,300	18'
Auditorium I	Permanent Theatre Seating for 118						
Prefunction Area	10,000 Square Feet						
Cedar	225	100	160	130	53' x 33'	1,749	8'-8'6"
Cedar A	60	35	45	40	37' x 17'	629	8'-8'6"
Cedar B	50	30	40	30	33' x 17'	561	8'-8'6"
Cedar C	50	30	40	30	33' x 17'	561	8'-8'6"
Oak	195	100	100	110	50' x 33'	1,650	8'-8'6"
Oak A	50	30	30	30	33' x 17'	629	8'-8'6"
Oak B	50	30	40	30	33' x 17'	561	8'-8'6"
Oak C	50	30	40	30	33' x 17'	561	8'-8'6"
Birch	50	30		40	24' x 24'	576	7'6"-8'

THIRD FLOOR
MEETING
ROOMS
PREFUNCTION
VICTORIA WING

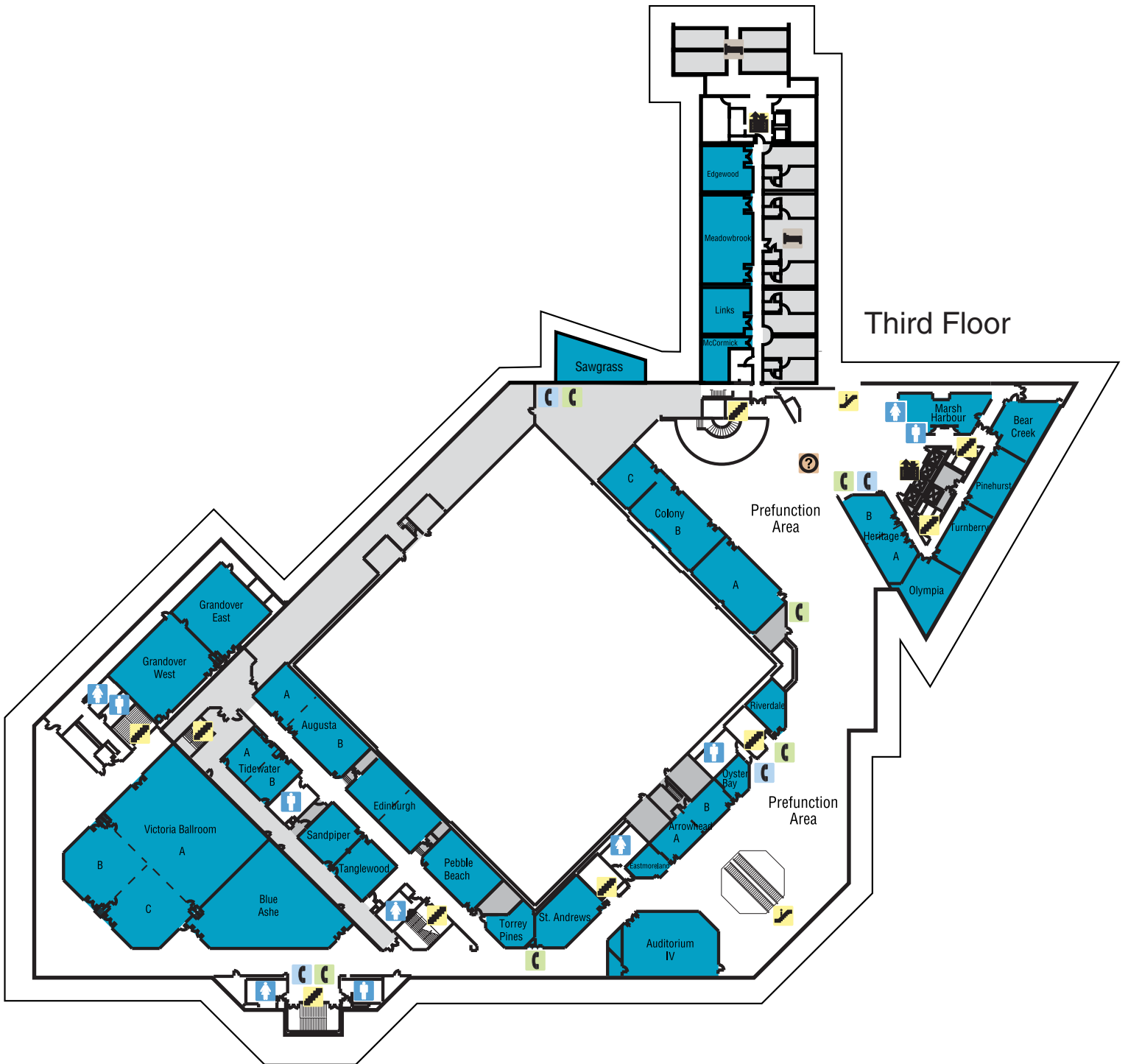

Third Floor